



U.S. Army Corps
of Engineers
Baltimore District

Public Notice

In Reply to Application Number
CENAB-OPR-M (SM DPW&T/ ST. JEROME CREEK DREDGING)
2017-60657

PN 17-25

Comment Period: May 23, 2017 to June 12, 2017

THE PURPOSE OF THIS PUBLIC NOTICE IS TO SOLICIT COMMENTS FROM THE PUBLIC REGARDING THE WORK DESCRIBED BELOW. NO DECISION HAS BEEN MADE AS TO WHETHER OR NOT A PERMIT WILL BE ISSUED AT THIS TIME.

This District has received an application for a Department of the Army permit pursuant to Section 10 of the Rivers and Harbors Act of 1899 and/or Section 404 of the Clean Water Act (33. U.S.C. 1344) as described below:

APPLICANT: St. Mary's County Department of Public Works & Transportation
P.O. Box 508
California, Maryland 20619

LOCATION: In the entrance channel of St. Jerome Creek between St. Jerome Neck Road and Murry Road, in Ridge, St. Mary's County, Maryland.

WORK: To dredge by either mechanical or hydraulic method a 77-foot wide by 406-foot long entrance channel impacting approximately 31,262 square foot (0.72 acre) area to a maximum depth of -6.5 feet mean low water resulting in approximately 2,000 cubic yards of sand to be deposited at an upland disposal site at Buzz's Marina. If you have any questions concerning this matter, please contact Mrs. Erica Schmidt of this office at (410) 962-6029 or via email at Erica.Schmidt@usace.army.mil.

The purpose of the project is to improve access to navigation.

As part of the planning process for the proposed project, steps were taken to ensure avoidance and minimization of impacts to waters of the United States to the maximum extent practicable. Compensatory mitigation is not being proposed by the applicant for impacts to open water (inter-tidal and sub-tidal) habitat or to the wetlands. No wetland impacts are proposed.

The Magnuson-Stevens Fishery Conservation and Management Act (MSFCMA), as amended by the Sustainable Fisheries Act of 1996 (Public Law 04-267), requires all Federal agencies to consult with the National Marine Fisheries Service (NMFS) on all actions, or proposed actions, permitted, funded, or undertaken by the agency that may adversely affect Essential Fish Habitat (EFH). The project site lies in or adjacent to EFH as described under Magnuson-Stevens Fishery Conservation and Management Act (MSFCMA) for Juvenile and adult Red hake (*Urophycis chuss*) and Windowpane flounder

(*Scophthalmus aquosus*); Adult Atlantic sea herring (*Clupea harengus*); Juvenile and adult Bluefish (*Pomatomus saltatrix*); Eggs, larvae, juvenile and adult Atlantic butterfish (*Peprilus triacanthus*); Larvae, juvenile and adult Summer flounder (*Paralichthys dentatus*); Juvenile and adult Scup (*Stenotomus chrysops*) and Red Drum (*Sciaenops ocellatus*); Eggs, larvae, juveniles and adult King mackerel (*Scomberomorus cavalla*), Spanish mackerel (*Scomberomorus maculatus*), Cobia (*Rachycentron canadum*), Black sea bass (*Centropristus striata*) and all managed species under the MSFCMA.

The project has the potential to adversely affect EFH or the species of concern by the alteration of spawning, nursery, forage and/or shelter habitat. The project may have an adverse effect on an approximate total of 0.72 acre area of EFH as described under the MSFCMA for the species and life stages identified above. This habitat consists of a mostly sand and silt substrate which does not support SAV. According to the Virginia Institute of Marine Science (VIMS) survey maps, there was no SAV within the area. The Baltimore District has made a preliminary determination that site-specific impacts would not be substantial and an abbreviated consultation will be conducted with NMFS. No mitigative measures are recommended at this time to minimize adverse effects on EFH. This preliminary determination may be modified if additional information indicates otherwise and could change the Corps' preliminary determination.

The decision whether to issue a permit will be based on an evaluation of the probable impacts, including cumulative impacts of the proposed activity on the public interest. That decision will reflect the national concern for both protection and utilization of important resources. The benefit, which reasonable may be expected to accrue from the proposal, must be balanced against its reasonably foreseeable detriments. All factors, which may be relevant to the proposal will be considered, including the cumulative effects thereof; among those are conservation, economic, aesthetics, general environmental concerns, wetlands, cultural values, fish and wildlife values, flood hazards, flood plain values, land use, navigation, shoreline erosion and accretion, recreation, water supply and conservation, water quality, energy needs, safety, food and fiber production, mineral needs, and consideration of property ownership and in general, the needs and welfare of the people.

The Corps of Engineers is soliciting comments from the public; Federal, State, and local agencies and officials; Indian Tribes; and other interested parties in order to consider and evaluate the impacts of this proposed activity. Any comments received will be considered by the Corps of Engineers to determine whether to issue, modify, condition or deny a permit for this proposal. To make this decision, comments are used to assess impacts on endangered species, historic properties, water quality, general environmental effects, and the other public interest factors listed above.

Comments are used in the preparation of an Environmental Assessment and/or an Environmental Impact Statement pursuant to the National Environmental Policy Act. Comments provided will become part of the public record for this action. Comments are also used to determine the need for a public hearing and to determine the overall public interest of the proposed activity. Written comments concerning the work described above

related to the factors listed above or other pertinent factors must be received by the District Engineer, U.S. Army Corps of Engineers, Baltimore District, 10 S. Howard Street, Baltimore, Maryland, 21201 within the comment period specified above.

Where applicable, the applicant has certified in this application that the proposed activity complies with and will be conducted in a manner consistent with the approved Coastal Zone Management (CZM) Program. By this public notice, we are requesting the State concurrence or objection to the applicant's consistency statement. It should be noted that the CZM Program has a statutory limit of 6 months to make its consistency determination.

The applicant must obtain any State or local government permits which may be required.

A preliminary review of this application indicates that the proposed work may affect but is not likely to adversely affect Federal listed threatened or endangered species or their critical habitat, pursuant to Section 7 of the Endangered Species Act, as amended. As the evaluation of this application continues, additional information may become available which could modify this preliminary determination.

Review of the latest published version of the National Register of Historic Places indicates that no registered properties listed as eligible for inclusion, therein, are located at the site of the proposed work. Currently unknown archeological, scientific, prehistoric, or historical data may be lost or destroyed by the work to be accomplished under the request permit.

Any person who has an interest which may be adversely affected by the issuance of this permit may request a public hearing. The request, which must be in writing, must be received by the District Engineer, U.S. Army Corps of Engineers, Baltimore District, 10 S. Howard Street, 21201, within the comment period as specified above to receive consideration. Also it must clearly set forth the interest which may be adversely affected by this activity and the manner in which the interest may be adversely affected.

It is requested that you communicate this information concerning the proposed work to any persons known by you to be interested and not being known to this office, who did not receive a copy of this notice.

FOR THE DISTRICT ENGINEER:

KATHY B. ANDERSON
Chief, Maryland Section Southern

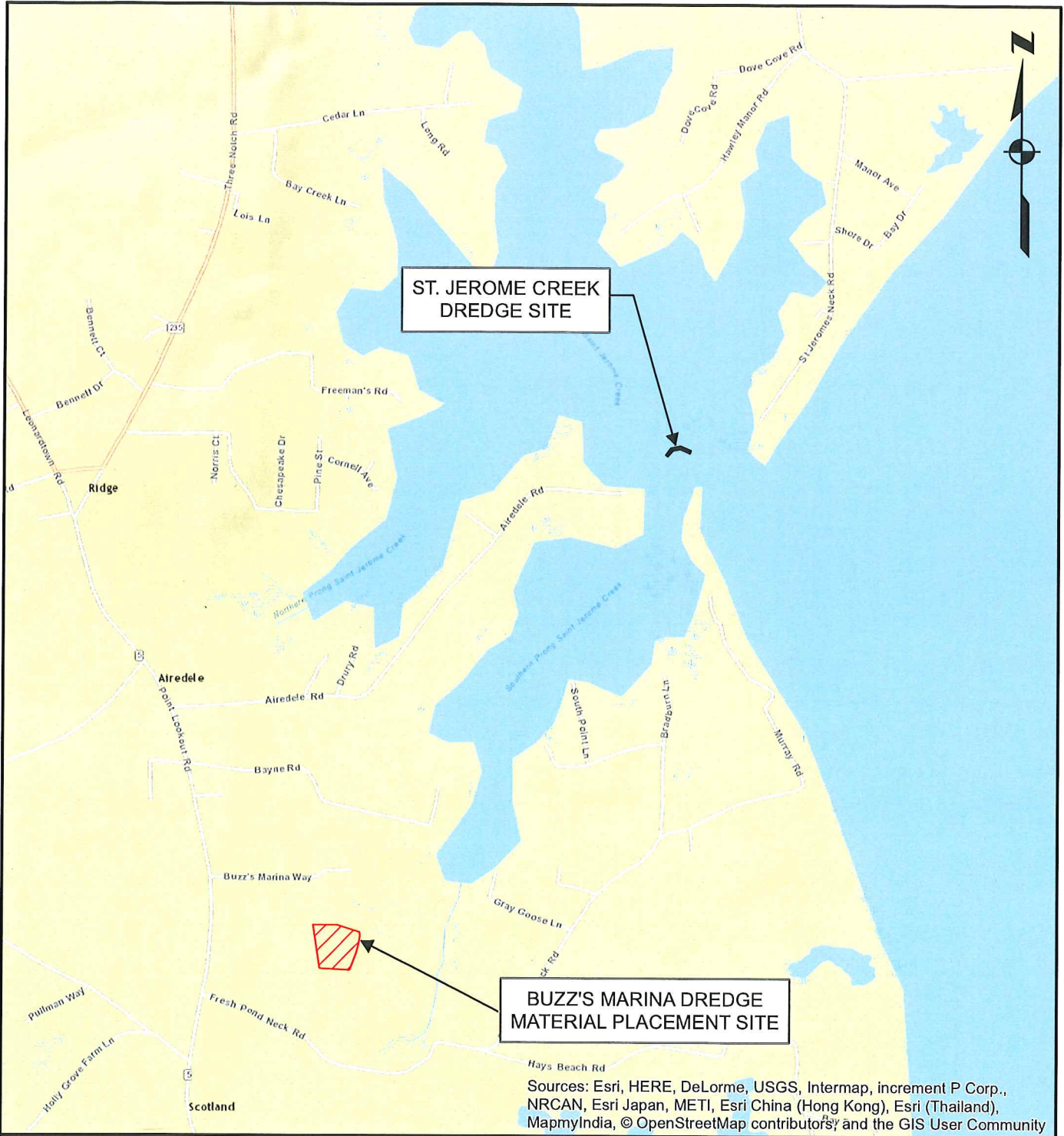

Sources: Esri, HERE, DeLorme, USGS, Intermap, increment P Corp., NRCAN, Esri Japan, METI, Esri China (Hong Kong), Esri (Thailand), MapmyIndia, © OpenStreetMap contributors, and the GIS User Community

Proposed Dredging

St. Jerome Creek
 St. Mary's County, MD
 Appl. By: St. Mary's County
 Department of Public Works

Date: March 2017

Sheet 1 of 7

VICINITY MAP

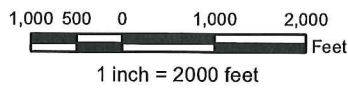



Proposed Dredging

DREDGE SITE - AERIAL PHOTO

St. Jerome Creek
St. Mary's County, MD
Appl. By: St. Mary's County
Department of Public Works
Date: March 2017
Sheet 2 of 7

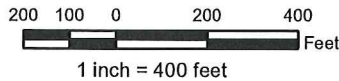

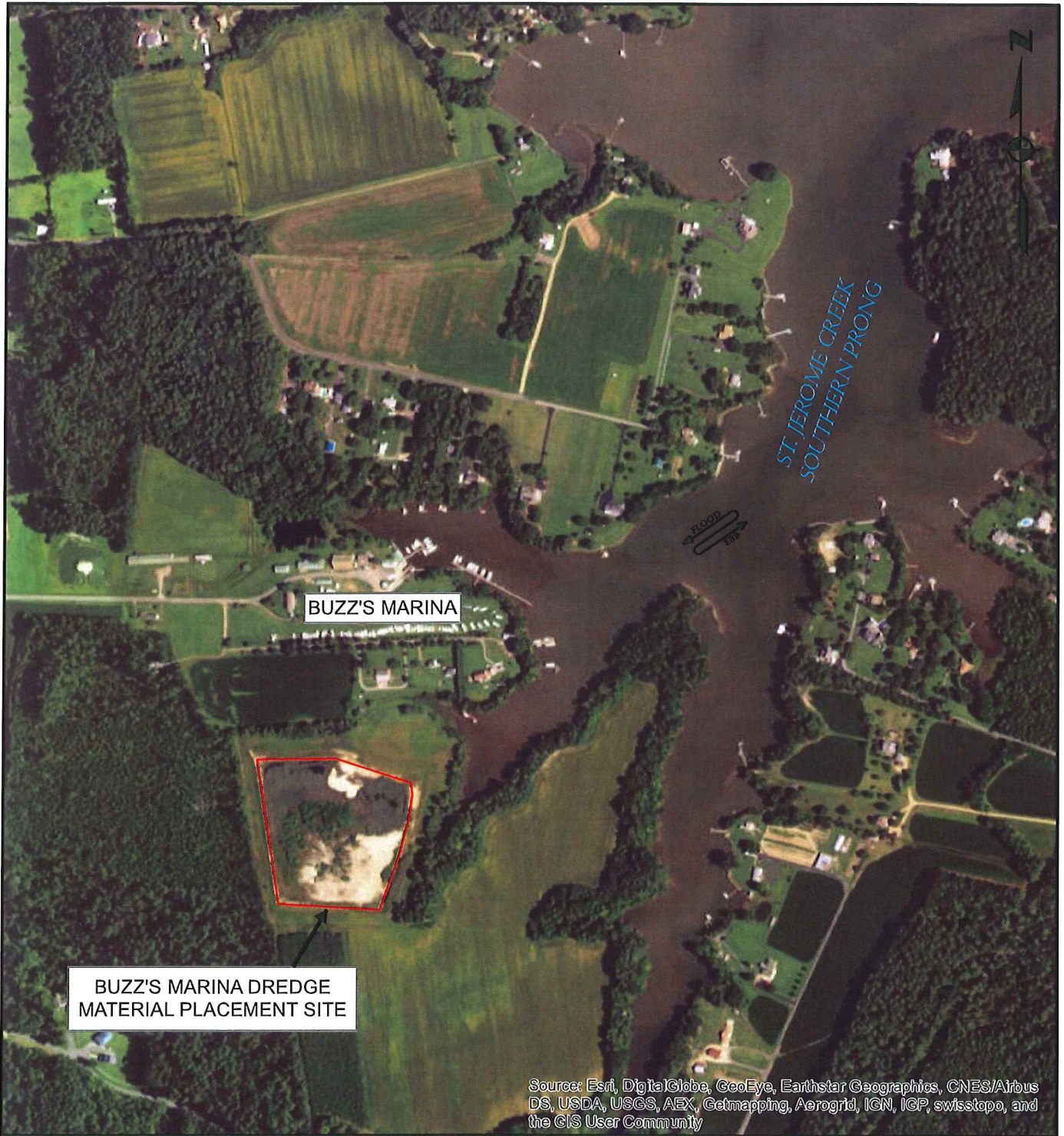

Proposed Dredging DREDGE MATERIAL PLACEMENT SITE - AERIAL PHOTO

St. Jerome Creek
St. Mary's County, MD
Appl. By: St. Mary's County
Department of Public Works

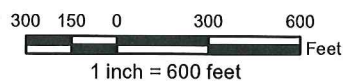

Date: March 2017
Sheet 3 of 7

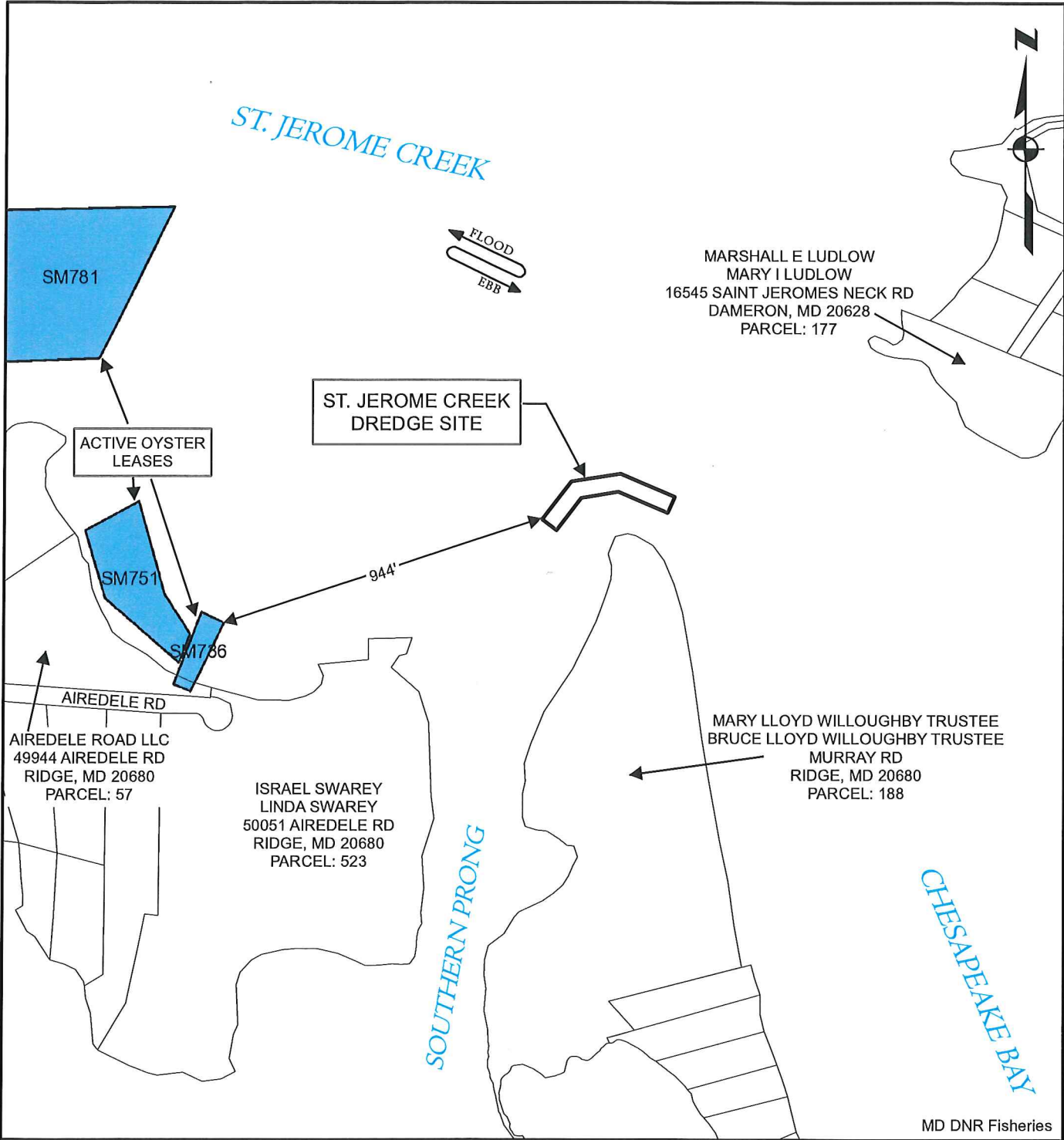

MD DNR Fisheries

Proposed Dredging ADJACENT PROPERTY OWNERS

St. Jerome Creek
 St. Mary's County, MD
 Appl. By: St. Mary's County
 Department of Public Works
 Date: March 2017
 Sheet 4 of 7

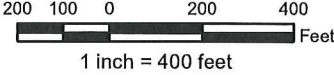

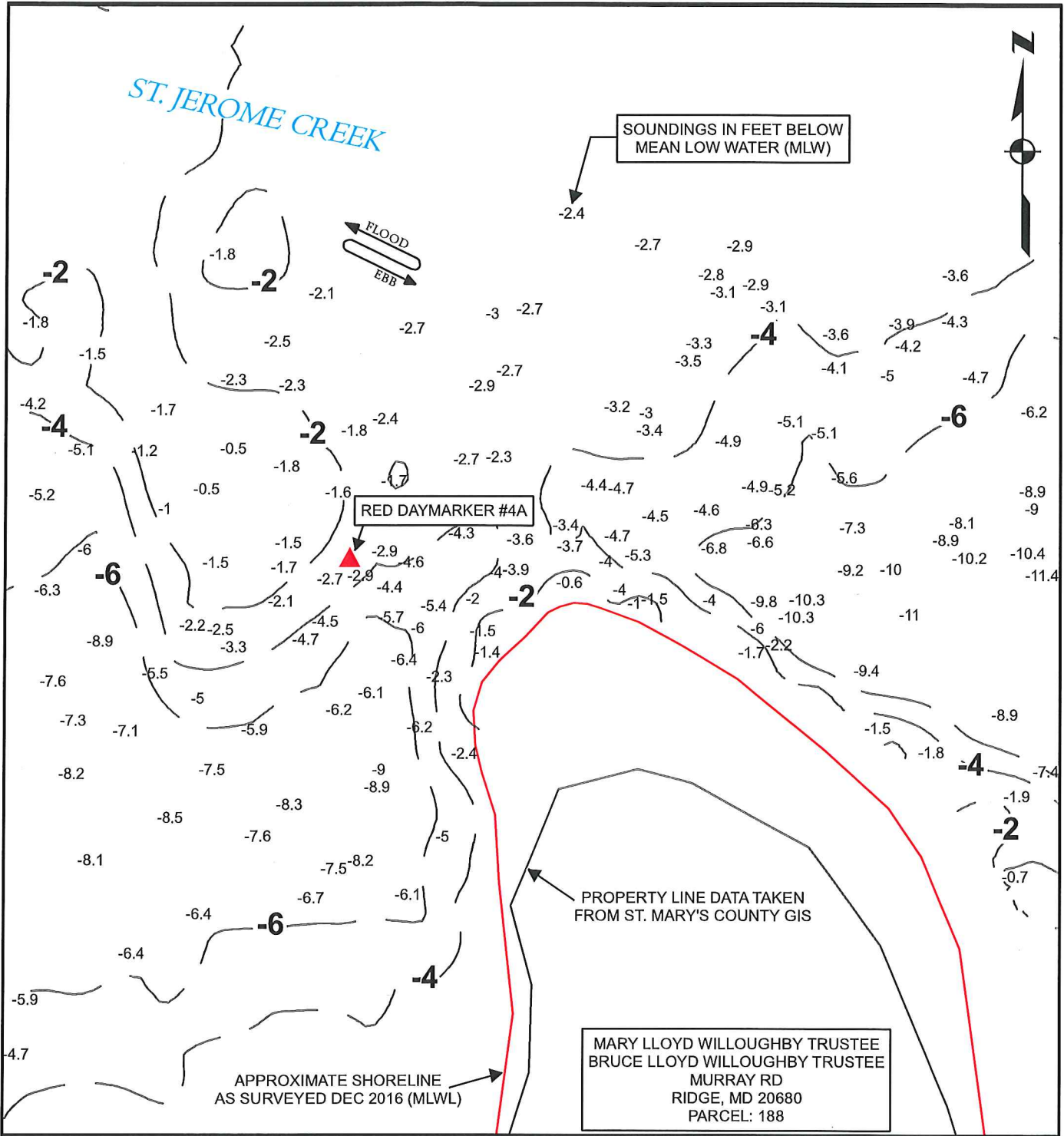

Proposed Dredging

EXISTING CONDITIONS

St. Jerome Creek
 St. Mary's County, MD
 Appl. By: St. Mary's County
 Department of Public Works

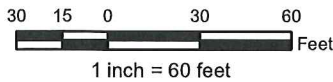

Date: March 2017
 Sheet 5 of 7

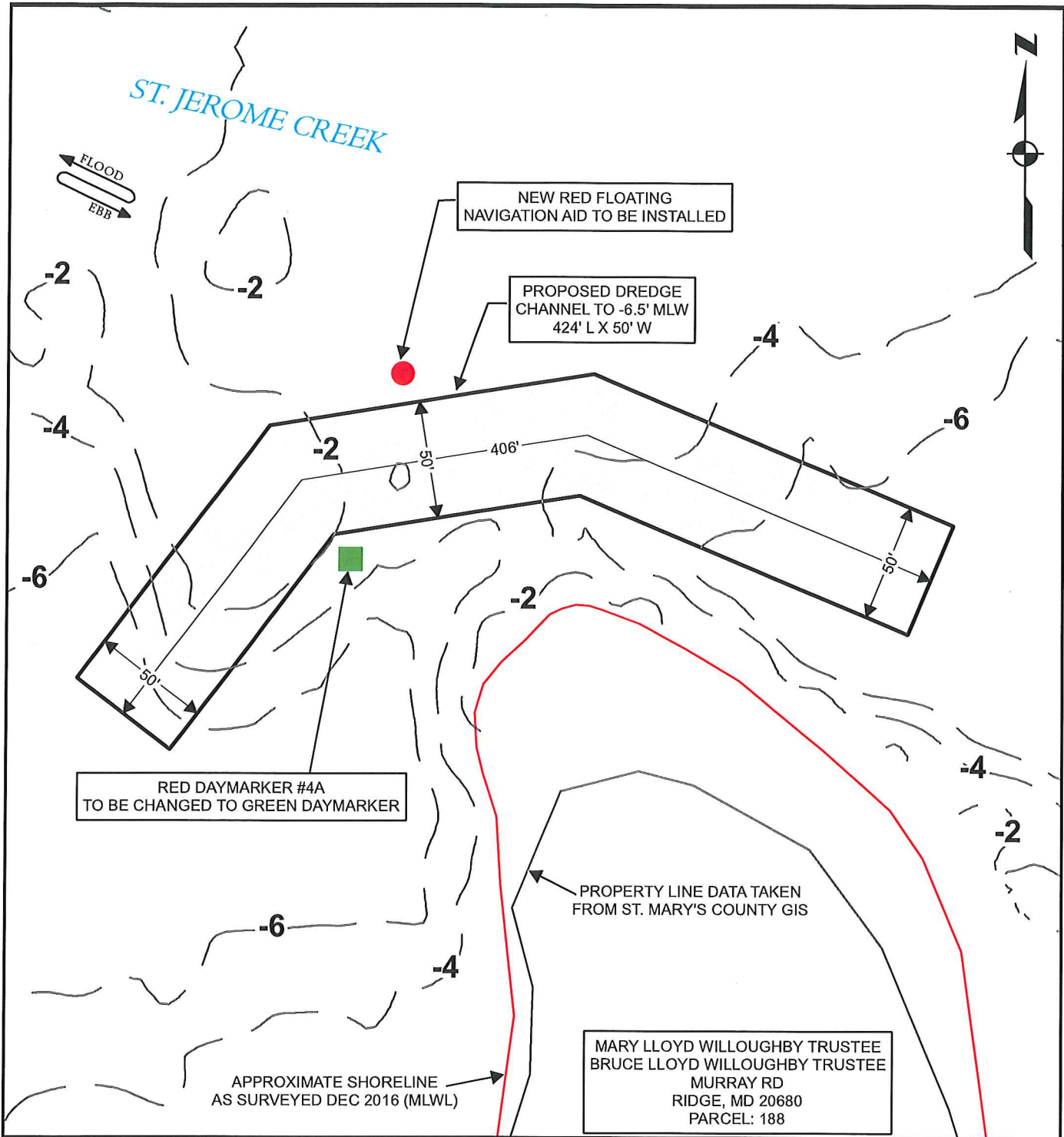

Proposed Dredging

St. Jerome Creek
St. Mary's County, MD
Appl. By: St. Mary's County
Department of Public Works

Date: March 2017

Sheet 6 of 7

CHANNEL PLAN

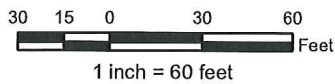

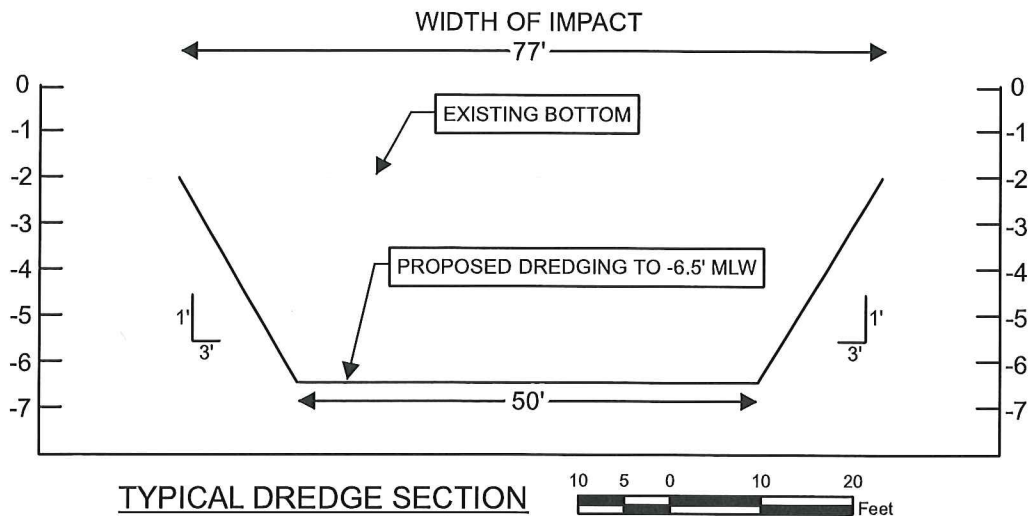

PROJECT DETAILS:

CHANNEL LENGTH:	406 FEET
CHANNEL WIDTH:	50 FEET
TOTAL CHANNEL AREA:	20320 SQUARE FEET
DREDGE AREA:	16096 SQUARE FEET
DREDGE MATERIAL QUANTITY:	2000 CUBIC YARDS
MAX. PROPOSED DREDGE DEPTH:	-6.5 FEET BELOW MLW
ADDRESS OF DMP SITE:	49675 Buzz's Marina Way Ridge, MD 20680 LAT: 38° 06' 3.0" N LONG: 76° 21' 33.0" W

PROJECT NOTES:

1. PROPOSED DREDGING OF ST. JEROME CREEK ENTRANCE, 406' L X 50' W TO -6.5' MLW DEPTH
2. BASEMAP IMAGERY TAKEN FROM ARCGIS DATED AUGUST 2015.
3. PROPERTY LINE DATA TAKEN FROM ST. MARY'S COUNTY GIS.
4. OYSTER LEASE AREAS TAKEN FROM DNR GIS.
5. TIDAL RANGE IS 1.3 FEET.
6. BATHYMETRY IS FROM DNR SURVEY DATED DECEMBER 20, 2016.
7. SOUNDINGS ARE IN FEET BELOW MEAN LOW WATER (MLW).

Proposed Dredging

St. Jerome Creek
 St. Mary's County, MD
 Appl. By: St. Mary's County
 Department of Public Works
 Date: March 2017
 Sheet 7 of 7

**CROSS SECTION &
 CHANNEL DETAILS**